

WV01
Wi-Fi IP CAMERA

QUICK START GUIDE



1

In the Box



Wi-Fi IP Camera



QR Code Card



USB cable

2

Getting started

1. Please check that your smart phone app is updated.
2. Please also check that your Wi-Fi router is working properly and operates on 802.11b/g/n 2.4GHz with WPA/WPA2 encryption. We also support OPEN encryption. i.e. no password

 **2.4GHz is the standard connection for most routers.**
Please do **NOT** choose 5GHz connection.

Product Features

1. Control, stream & playback videos via app
2. Record videos (MicroSD card is required)
3. 2-way Audio (Talk and listen)
4. Night Vision
5. Built-in Wi-Fi module
6. Life-time cloud service is included
7. Powerful APP for your Smartphone provided
8. Powered by DC 5V USB (microUSB)

3

Installing the APP

1. Before powering up the device, please install our free NetzGuard APP onto your phone.
2. Now complete your User Profile by inputting your email address and a 6-to-20-digit password.



NetzGuard



4

Setting up your DEVICE



1. Open the NetzGuard App.
2. Tap **Add a device**.
3. Select **Set up new camera/ Setup Device**
4. Power on your camera with DC5V USB. Wait for "System Ready" If not, please power down for 5sec. and power up again.
5. Press and hold the reset button for 5 seconds until you can hear "System Reset". Wait for " Camera is now ready to begin pairing."

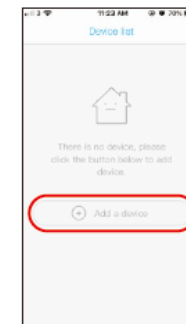

5

Input your Wi-Fi password and press **Next**.

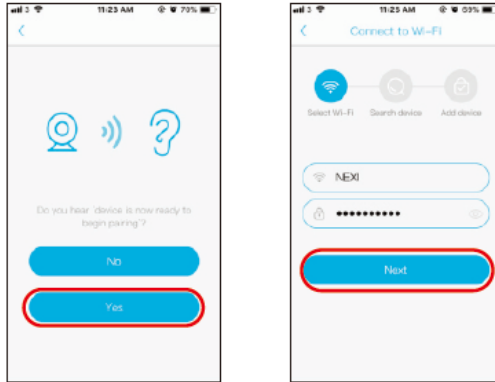

6

The camera is connecting to your app. Please set your device name and password and press **Finish**. Select the location and press **Submit**.

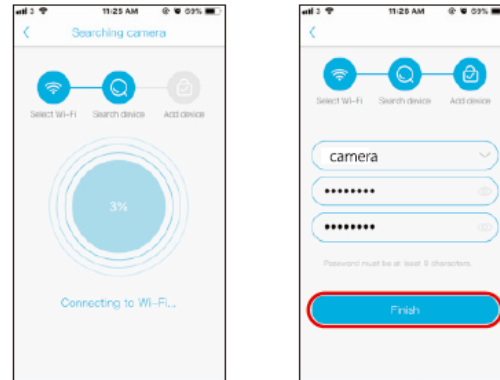

7

How To Use

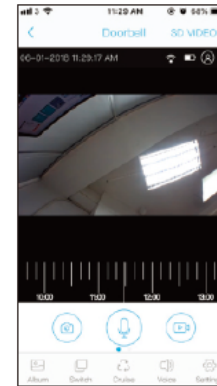

*To capture real-time photos.









* To capture real-time videos. Please record the video for at least 5 secs to ensure it is successfully recorded.



Talk to the user beside the camera .

8

*Photos and videos will be saved in  Album files.

-  Press  to enlarge the video screen.
-  Press  , camera cruise a circle automatically.
-  Toggle to hear the sound from camera or to mute.
-  Press to advanced setting.

9

Trouble Shooting

CANNOT PAIR THE CAMERA SUCCESSFULLY

1. Check whether the camera is powered by micro USB (DC 5V)
2. If there are too many Wi-Fi connections around your device, turn them off to avoid any disturbance and pair again.
3. Check that the router is working properly and that it operates on 2.4GHz.
4. Check that the SSID and password are correct.

DOESN'T WORK PROPERLY or LOSS OF SIGNAL

1. Check whether the device is within coverage of your Wi-Fi router/repeater. Move the device or router to a different location
2. Check that the router is working properly

CANNOT RECORD VIDEOS

1. Check whether the camera has inserted microSD card.
2. Change the recording mode to "Record full-time".

10

THANK YOU